



Carters Road | Upton | Ryde | PO33 4BP

Asking Price £95,000



Carters Road | Upton
 Ryde | PO33 4BP
 Asking Price £95,000

This modern detached park home is located on the rural site of Roebeck Country Park between Havenstreet and Upton. The property is set on a corner plot has modern lighting and styling throughout, it comprises of a large open plan kitchen/lounge/diner with access to private decking area, modern bathroom and 2 double bedrooms with the master benefitting from an en-suite.

Outside you have wrap around decking, large communal green area to the side and private driveway for 2/3 cars.

- 2 BEDROOMS
- MASTER WITH EN-SUITE
- RURAL LOCATION
- LARGE DRIVEWAY
- MODERN INTERIOR
- GAS CENTRAL HEATING AND DOUBLE GLAZED

Lounge/Kitchen/Diner

Hallway

Master bedroom

En-suite

Guest Bedroom

Bathroom

Outside



GROUND FLOOR

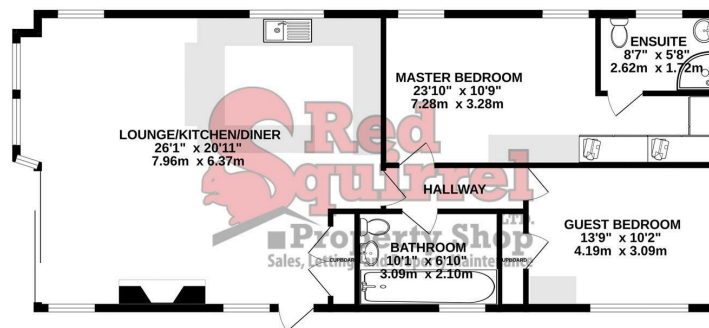

Whilst every attempt has been made to ensure the accuracy of the floorplan contained here, measurements of doors, windows, rooms and any other items are approximate and no responsibility is taken for any error, omission or mis-statement. This plan is for illustrative purposes only and should be used as such by any prospective purchaser. The services, systems and appliances shown have not been tested and no guarantee as to their operation or efficiency can be given.
 Made with Metropix 10/2023

Energy Efficiency Rating		
	Current	Potential
Very energy efficient - lower running costs		
(92 plus) A		
(81-91) B		
(69-80) C		
(55-68) D		
(39-54) E		
(21-38) F		
(1-20) G		
Not energy efficient - higher running costs		
England & Wales	EU Directive 2002/91/EC	

Council Tax Band
 EPC Rating

3 Langely Court Pyle Street
 Newport
 Isle of Wight
 PO30 1LA
 01983 521212

enquiries@redsquirrelpropertyshop.co.uk
 www.redsquirrelpropertyshop.co.uk